



Nominal Diameter

2,5 = 6,25 mm²

TEMA Series

THP1000

60% of actual size

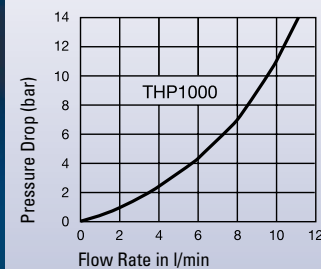
Flow Capacity Viscosity
for 37cSt at 40°C
as per ISO 7241/2-2000
**Technical Description**

The TEMA high pressure coupling was specially developed for use in industrial machinery, salvage devices and testing equipment. This series is galvanised and produced in steel. The plug part and the sleeve are hardened and galvanised in steel. The coupling can be supplied either with or without additional safety lock.

Advantages

High flow as a result of optimised valve design. Additional plug sealing via polymer valve casing, to guarantee high reliability seals even with second-hand plugs. TEMA high pressure couplings are supplied with dust caps inclusive!

Seals

Coupling:
bonded seal washer
Plug:
bonded seal or innercone
(Bonded steel washer s. page 447)

Interchangeability
CEJN 115**Working Pressure**
1000 bar**Working Temperature**
-30°C up to +100°C (NBR)**Available Valves****Material****Coupling**

Coupling Body
Sleeve
Valve
Springs
Locking Balls
Seals
Inner Sleeve

Steel, Zinc Plated, passivated, sealed
Steel, Hardened, Zinc Plated, passivated, sealed
Steel, Zinc Plated, Yellow passivated, sealed
AISI 301
AISI 420 C
NBR
POM

Plug

Plug Body
Valve
Springs
Seals
Valve Holder

Steel, Hardened, Zinc Plated, passivated, sealed
Steel, Zinc Plated, Yellow passivated, sealed
AISI 301
NBR
Steel, Galvanised

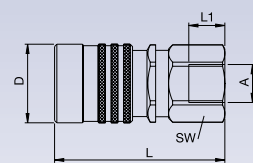
Couplings**TEMA Series THP1000**

Female Thread

| Connection A | Hex SW | L mm | L1 mm | D mm | Safety Locking | Working press. coupled in bar | Working press. uncoupled in bar | Bursting Press. coup. in bar | Part Number | DS |
|--------------|--------|------|-------|------|----------------|-------------------------------|---------------------------------|------------------------------|-------------|----|
| G 1/4 | 24 | 59 | 12 | 27 | without | 1000 | 1000 | >3000 | THP10104131 | ■ |
| G 1/4 | 24 | 59 | 12 | 27 | with | 1000 | 1000 | >3000 | THP10104132 | ■ |
| 1/4-18 NPTF | 24 | 59 | 12 | 27 | without | 1000 | 1000 | >3000 | THP10105131 | □ |
| 1/4-18 NPTF | 24 | 59 | 12 | 27 | with | 1000 | 1000 | >3000 | THP10105132 | □ |
| G 3/8 | 24 | 59 | 12 | 27 | without | 1000 | 1000 | >3000 | THP10104171 | ■ |
| G 3/8 | 24 | 59 | 12 | 27 | with | 1000 | 1000 | >3000 | THP10104172 | □ |
| 3/8-18 NPTF | 24 | 59 | 13 | 27 | without | 1000 | 1000 | >3000 | THP10105171 | □ |
| 3/8-18NPTF | 24 | 59 | 13 | 27 | with | 1000 | 1000 | >3000 | THP10105172 | □ |

DS = Delivery Status: ■ in stock

□ on short call

□ medium term delivery

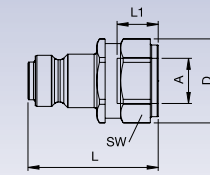
Plugs**TEMA Series THP1000**

Female Thread

| Connection A | Hex SW | L mm | L1 mm | D mm | Working press. coupled in bar | Working press. uncoupled in bar | Bursting Press. coupled in bar | Part Number | DS |
|--------------|--------|------|-------|------|-------------------------------|---------------------------------|--------------------------------|-------------|----|
| G 1/4 | 22 | 37 | 12 | 24,5 | 1000 | 1000 | >3000 | THP1020413 | ■ |
| 1/4-18 NPTF | 22 | 37 | 12 | 24,5 | 1000 | 1000 | >3000 | THP1020513 | □ |
| G 3/8 | 24 | 37 | 12 | 24,5 | 1000 | 1000 | >3000 | THP1020417 | ■ |
| 3/8-18 NPTF | 24 | 37 | 13 | 24,5 | 1000 | 1000 | >3000 | THP1020517 | □ |

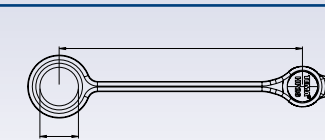
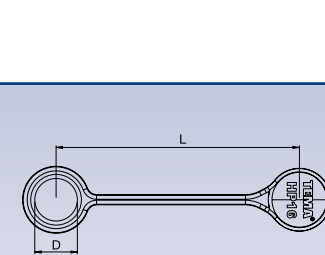
Dust Protection**TEMA Series THP1000**

| Description | L mm | D mm | Colour | Material | Part Number | DS |
|-------------|------|------|--------|-----------|-------------|----|
| Coupling | 120 | 21 | Blue | PVC | THP16 | □ |
| Coupling | 125 | - | Red | Aluminium | THP16ARD | □ |
| Plug | 120 | 19 | Blue | PVC | THP26 | □ |
| Plug | 140 | - | Red | Aluminium | THP26ARD | □ |

DS = Delivery Status:

■ in stock

□ on short call

□ medium term delivery

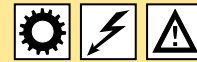

Nominal Diameter

2,5 = 6,25 mm²

TEMA Series

THP1500

auf 60% verkleinert

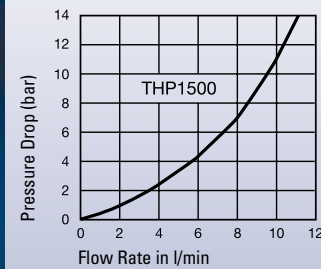
**Flow Capacity Viscosity
for 37cSt at 40°C
as per ISO 7241/2-2000**

Technical Description

The TEMA high pressure coupling was specially developed for use in bolt tensioning equipment. This series is produced in steel. The coupling body is QPQ-treated. The plug bodies are black galvanised. The coupling can be supplied either with or without additional safety lock.

Advantages

High flow as a result of optimised valve design. Additional plug sealing via polymer valve casing, to guarantee high reliability seals even with second-hand plugs. TEMA high pressure couplings are supplied with dust caps inclusive!

Seals

Metal sealing cone threaded adapters/metal sealing cone adapters.

Interchangeability

CEJN 116

Working Pressure

1500 bar

Working Temperature

-30°C up to +100°C (NBR)

Available Valves

Material
Coupling

Coupling Body
Sleeve
Valve
Springs
Locking Balls
Seals
Inner Sleeve

Steel, Zinc-iron coated, black passivated, sealed
Steel, Hardened, Zinc-iron coated, black passivated, sealed
Steel, Zink Plated, Yellow passivated, sealed
AISI 301
AISI 420 C
NBR
POM

Plug

Plug Body
Valve
Springs
Seals
Valve Holder

Steel, Hardened, Zinc-iron coated, black passivated, sealed
Steel, Zink Plated, Yellow passivated, sealed
AISI 301
NBR
Steel, Galvanised

Couplings
TEMA Series THP1500

| Connection A | Hex SW | L mm | L1 mm | D mm | Safety Locking | Working press. coupled in bar | Working press. uncoupled in bar | Bursting Press. coup. in bar | Part Number | DS |
|--------------|--------|------|-------|------|----------------|-------------------------------|---------------------------------|------------------------------|-------------|----|
| G 1/4 | 24 | 59 | 12 | 27 | without | 1500 | 1500 | >3500 | THP15104131 | ■ |
| G 1/4 | 24 | 59 | 12 | 27 | with | 1500 | 1500 | >3500 | THP15104132 | ■ |
| 1/4-18 NPTF | 24 | 59 | 12 | 27 | without | 1500 | 1500 | >3500 | THP15105131 | ■ |
| 1/4-18 NPTF | 24 | 59 | 12 | 27 | with | 1500 | 1500 | >3500 | THP15105132 | ■ |
| G 3/8 | 24 | 59 | 12 | 27 | without | 1500 | 1500 | >3500 | THP15104171 | ■ |
| G 3/8 | 24 | 59 | 12 | 27 | with | 1500 | 1500 | >3500 | THP15104172 | ■ |
| 3/8-18 NPTF | 24 | 59 | 13 | 27 | without | 1500 | 1500 | >3500 | THP15105171 | ■ |
| 3/8-18 NPTF | 24 | 59 | 13 | 27 | with | 1500 | 1500 | >3500 | THP15105172 | ■ |

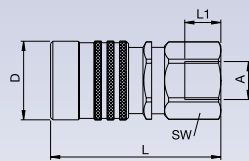
Female Thread

DS = Delivery Status: ■ in stock

■ on short call

■ medium term delivery

Plugs
TEMA Series THP1500

| Connection A | Hex SW | L mm | L1 mm | D mm | Working press. coupled in bar | Working press. uncoupled in bar | Bursting Press. coupled in bar | Part Number | DS |
|--------------|--------|------|-------|------|-------------------------------|---------------------------------|--------------------------------|-------------|----|
| G 1/4 | 22 | 38 | 12 | 24,5 | 1500 | 1500 | >3500 | THP1520413 | ■ |
| 1/4-18 NPTF | 22 | 38 | 12 | 24,5 | 1500 | 1500 | >3500 | THP1520513 | ■ |

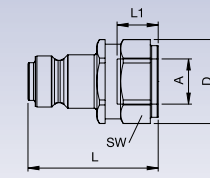
Female Thread
Dust Protection
TEMA Series THP1500

| Description | L mm | D mm | Color | Material | Part Number | DS |
|-------------|------|------|-------|-----------|-------------|----|
| Coupling | 120 | 21 | Blue | PVC | THP16 | ■ |
| Coupling | 125 | - | Red | Aluminium | THP16ARD | ■ |
| Plug | 120 | 19 | Blue | PVC | THP26 | ■ |
| Plug | 140 | - | Red | Aluminium | THP26ARD | ■ |

DS = Delivery Status: ■ in stock

■ on short call

■ medium term delivery

Adapter HP-Series

TEMA Adapter

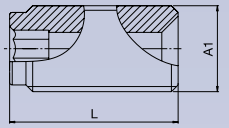
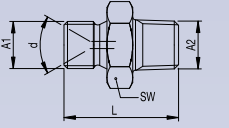
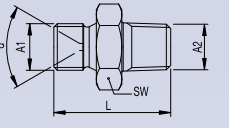
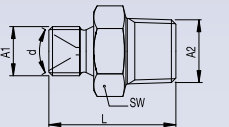
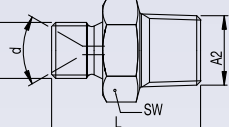
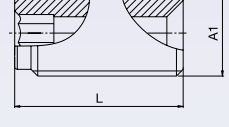
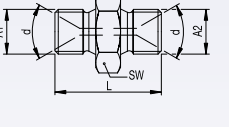
| | Working Press. in bar | Connection A1 | Seal 1 | Connection A2 | Seal 2 | L mm | Hex SW | Part Number | DS |
|---|-----------------------|---------------|----------------|---------------|----------------|------|--------|-------------|----|
|  | 1000 | G 1/4 o. | Rubber/Steel | | | 25 | | THP13-01 | ■ |
|  | 1000 | G 1/4 o. | Rubber/Steel | 1/4-18 NPTF | inside Thread | 32 | 21 | THP13-02 | ■ |
|  | 1000 | G 1/4 o. | Rubber/Steel | R 1/4 AG | inside Thread | 33 | 21 | THP13-03 | ■ |
|  | 1500 | G 1/4 o. | Rubber/Steel | 3/8-18 NPTF | inside Thread | 34 | 21 | THP13-04 | ■ |
|  | 1000 | G 1/4 o. | Rubber/Steel | R 3/8 AG | inside Thread | 35 | 21 | THP13-05 | ■ |
|  | 1500 | G 1/4 o. | Rubber/Steel | | | 25 | | THP13-06 | ■ |
|  | 2000 | G 1/4 o. | Inner Cone 60° | G 1/4 AG | Inner Cone 60° | 31,3 | 21 | THP13-07 | ■ |

DS = Delivery Status: ■ in stock

■ on short call

□ medium term delivery

Adapter HP-Series

TEMA Adapter

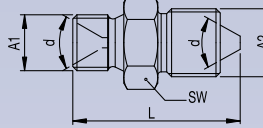
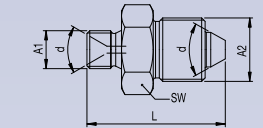
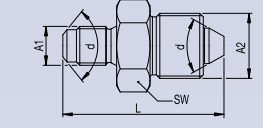
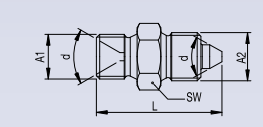
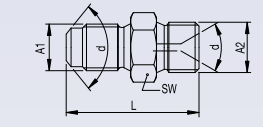
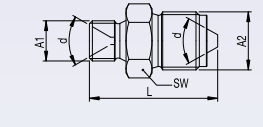
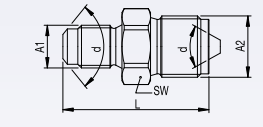
| | Working Press. in bar | Connection A1 | Seal 1 | Connection A2 | Seal 2 | L mm | Hex SW | Part Number | DS |
|---|-----------------------|---------------|-------------------|---------------|------------------|------|--------|-------------|----|
|  | 2000 | G 1/4 o. | Inner Cone 60° | M 16 x 1,5 AG | Outside Cone 60° | 39,4 | 19 | THP13-08 | ■ |
|  | 2000 | G 1/4 o. | Inner Cone 60° | M 22 x 1,5 AG | Outside Cone 60° | 48 | 27 | THP13-09 | ■ |
|  | 2000 | G 1/4 o. | Outside Cone 120° | M 22 x 1,5 AG | Outside Cone 60° | 54,5 | 27 | THP13-10 | ■ |
|  | 2000 | G 1/4 o. | Inner Cone 60° | 9/16-18 UNF | Outside Cone 60° | 37 | 17 | THP13-11 | ■ |
|  | 2000 | G 1/4 o. | Outside Cone 120° | 9/16-18 UNF | Inner Cone 60° | 37,5 | 17 | THP13-12 | ■ |
|  | 2000 | G 1/4 o. | Inner Cone 60° | 3/4-16 UNF | Outside Cone 60° | 42 | 21 | THP13-13 | ■ |
|  | 2000 | G 1/4 o. | Outside Cone 120° | 3/4-16 UNF | Outside Cone 60° | 48,5 | 21 | THP13-14 | ■ |

DS = Delivery Status: ■ in stock

■ on short call

□ medium term delivery

Further adapters and manifolds on request.